

IEA-EBC Annex 61 Graz



Social urban retrofit – the future of our energy bills

about systemchanges and where to start

**a mixture of
vision and
experience**

It all started in a cave



The ultimate do it yourself

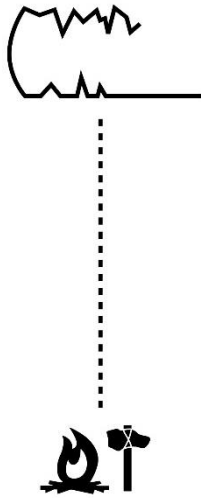

Specialization

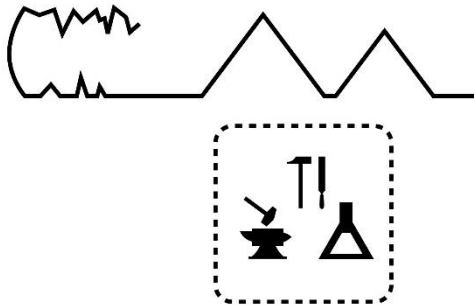

Cooperation

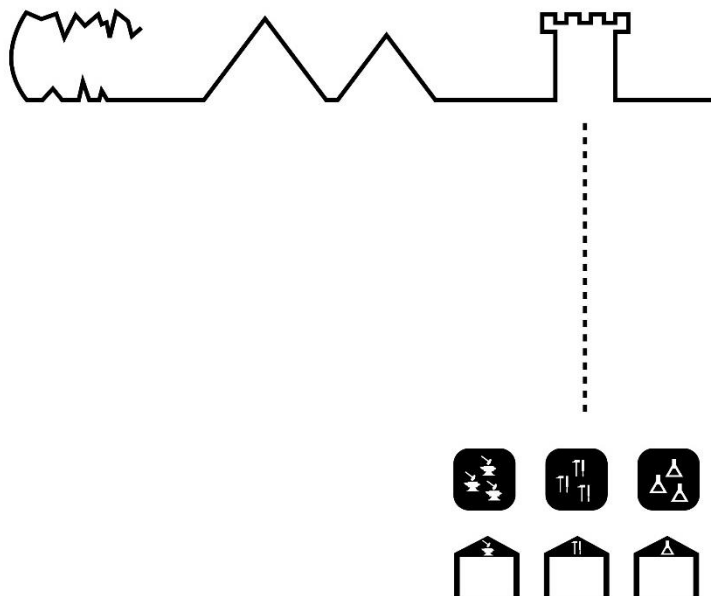

Industrialization

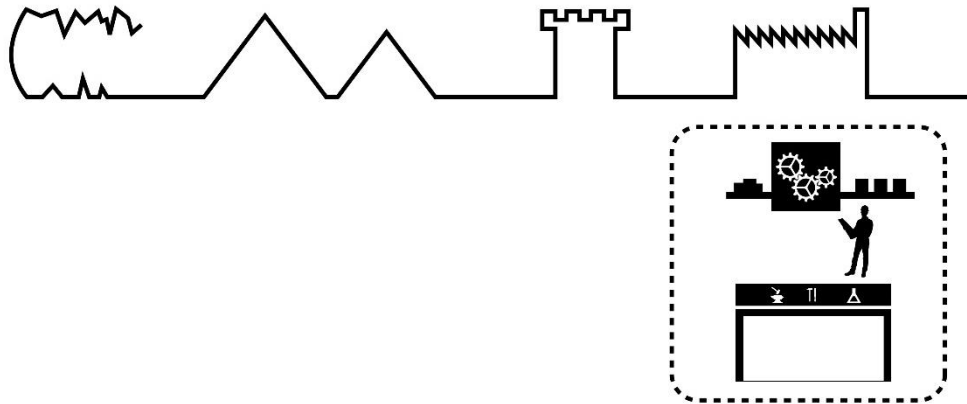

Service

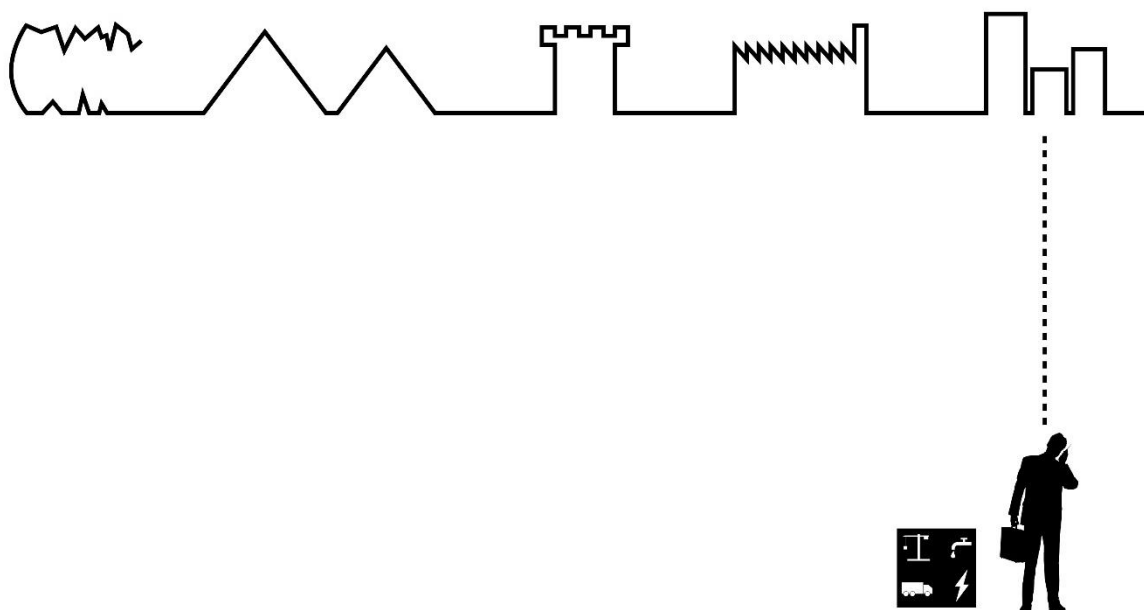

Information

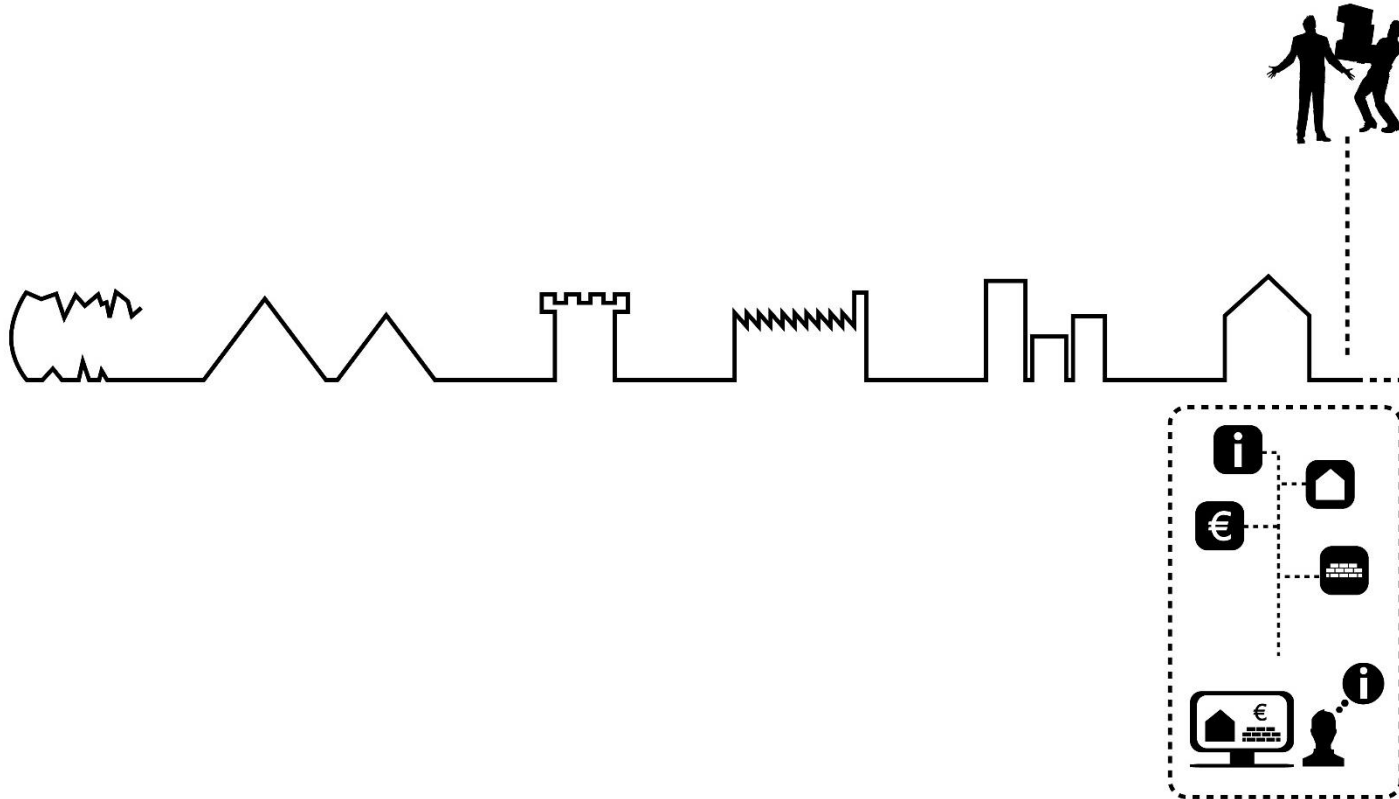

Why are our homes still medieval?

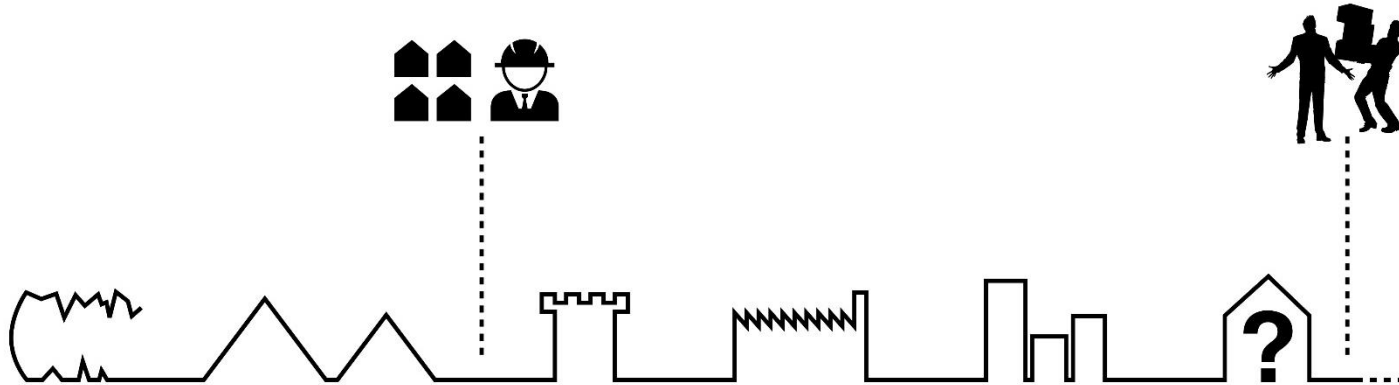

111 energieneutral social homes

Demolition and building proces within 25 days



111 energieneutral social homes

Demolition and building proces within 25 days

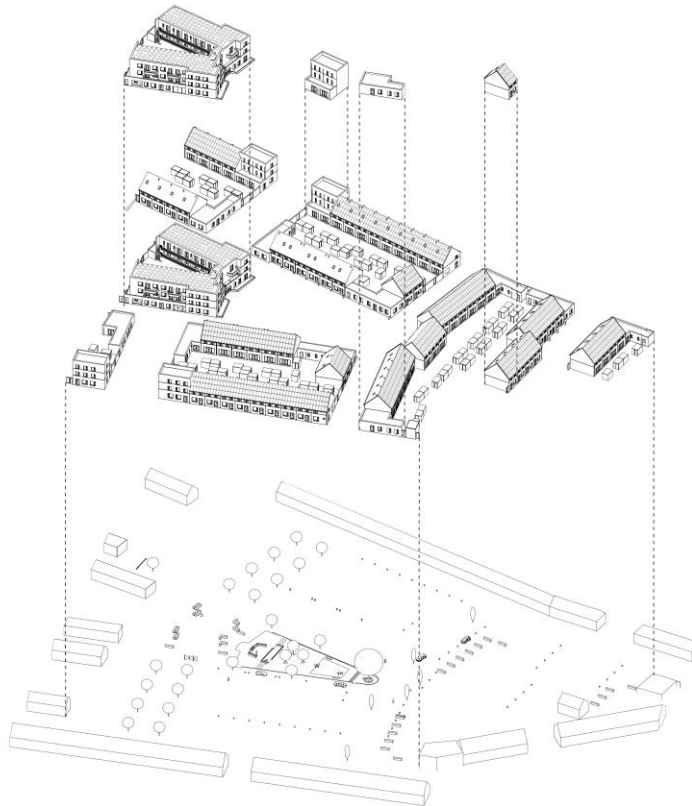

111 energieneutral social homes

Demolition and building proces within 25 days



additional investment

sustainability | living quality | organization | contextual quality of architecture

Home for elderly with dementia



Petterhusterstaete Stiens
rural region North-NL

Total cost of ownership

building | social | sustainable | economic

Development & Design
Building construction

100

Total cost of ownership

building | social | sustainable | economic

Development & Design
Building construction



Maintanace
Energy costs

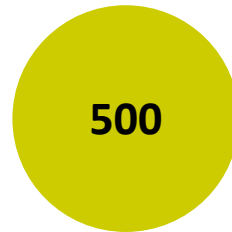

Total cost of ownership

building | social | sustainable | economic

Development & Design
Building construction



Maintanace
Energy costs

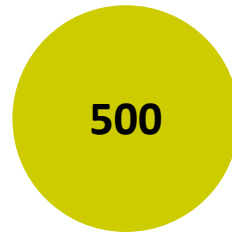

Activities
Staff

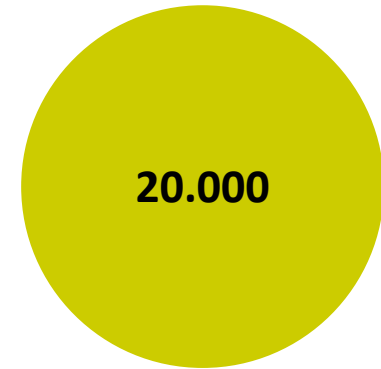

Total cost of ownership

building | social | sustainable | economic

Development & Design
Building construction



Maintanace
Energy costs



Activities
Staff

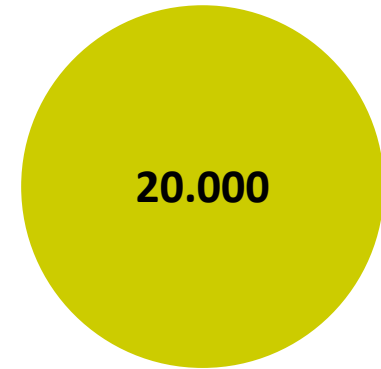

● - 2%

Total cost of ownership

building | social | sustainable | economic

Development & Design
Building construction



Maintanace
Energy costs



Activities
Staff

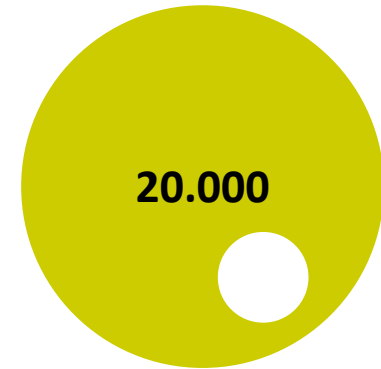

● - 2%

● - 0,45%

Total cost of ownership

building | social | sustainable | economic

Development & Design
Building construction

Maintanace
Energy costs

Activities
Staff

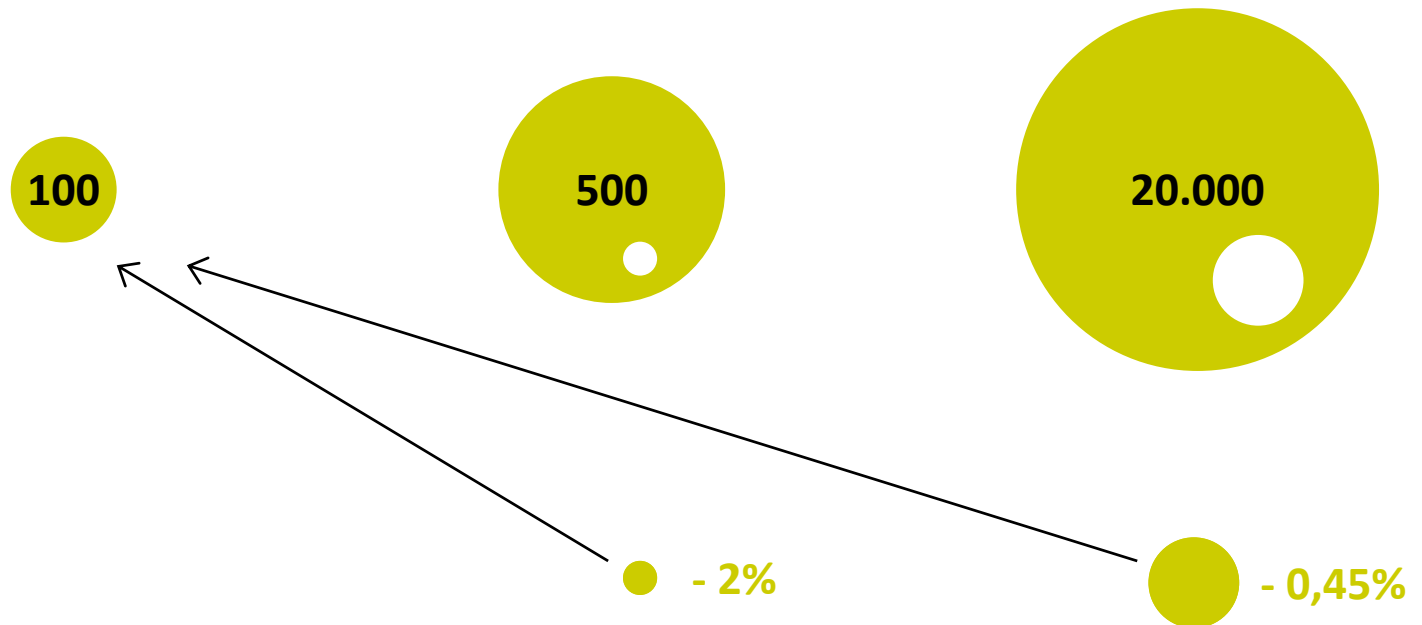

“Veilige Veste” [Safe Fortress]

A home for victims of violence, prostitution and human trafficking



The old policestation Leeuwarden

How we found it



The “new” Veilige Veste

How we left it



The “new” Veilige Veste

From prison cells to home



Financial relations

Investments and results through sustainable, high-standaard energy-saving retrofit

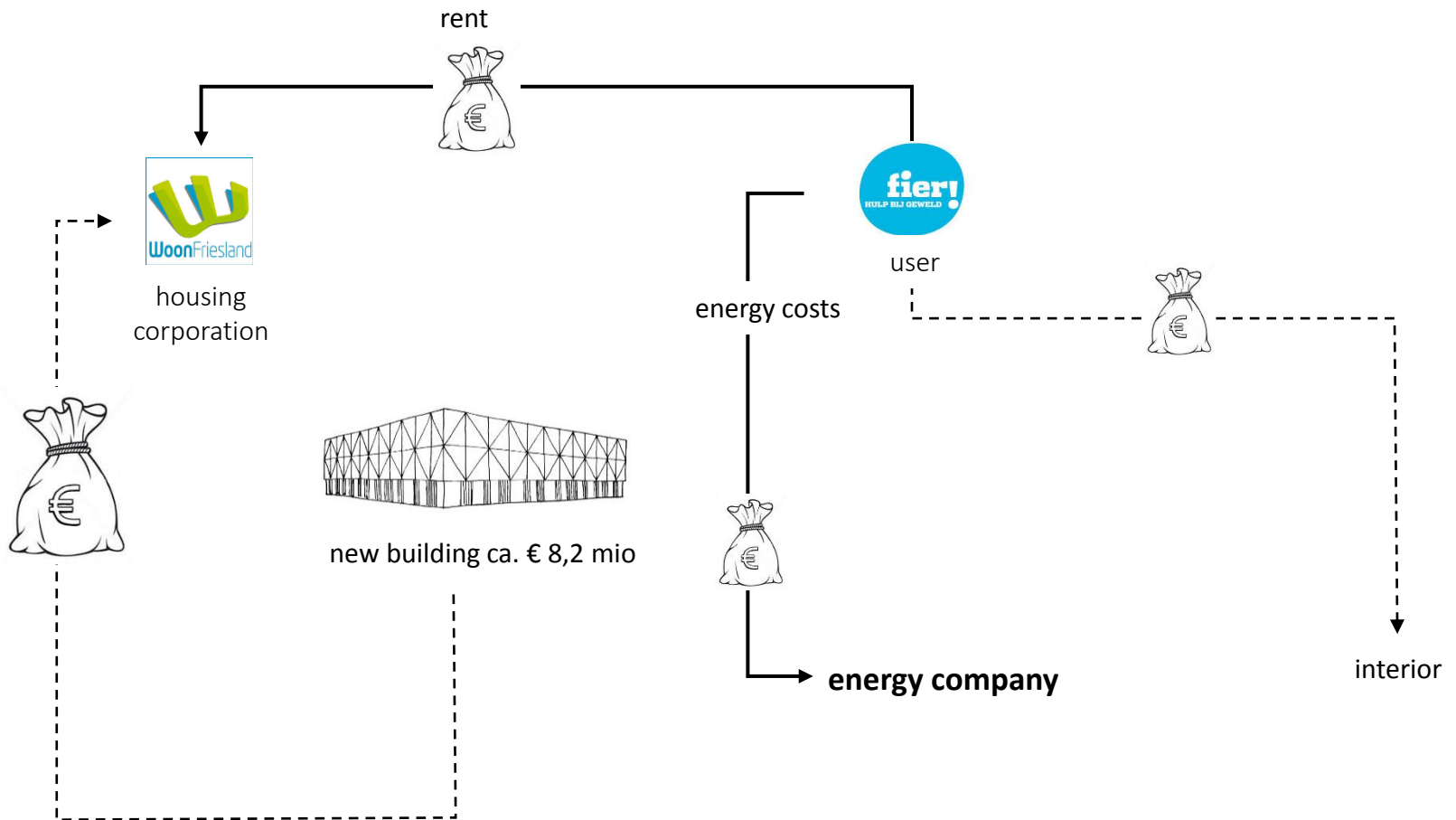

Financial relations

Investments and results through sustainable, high-standaard energy-saving retrofit

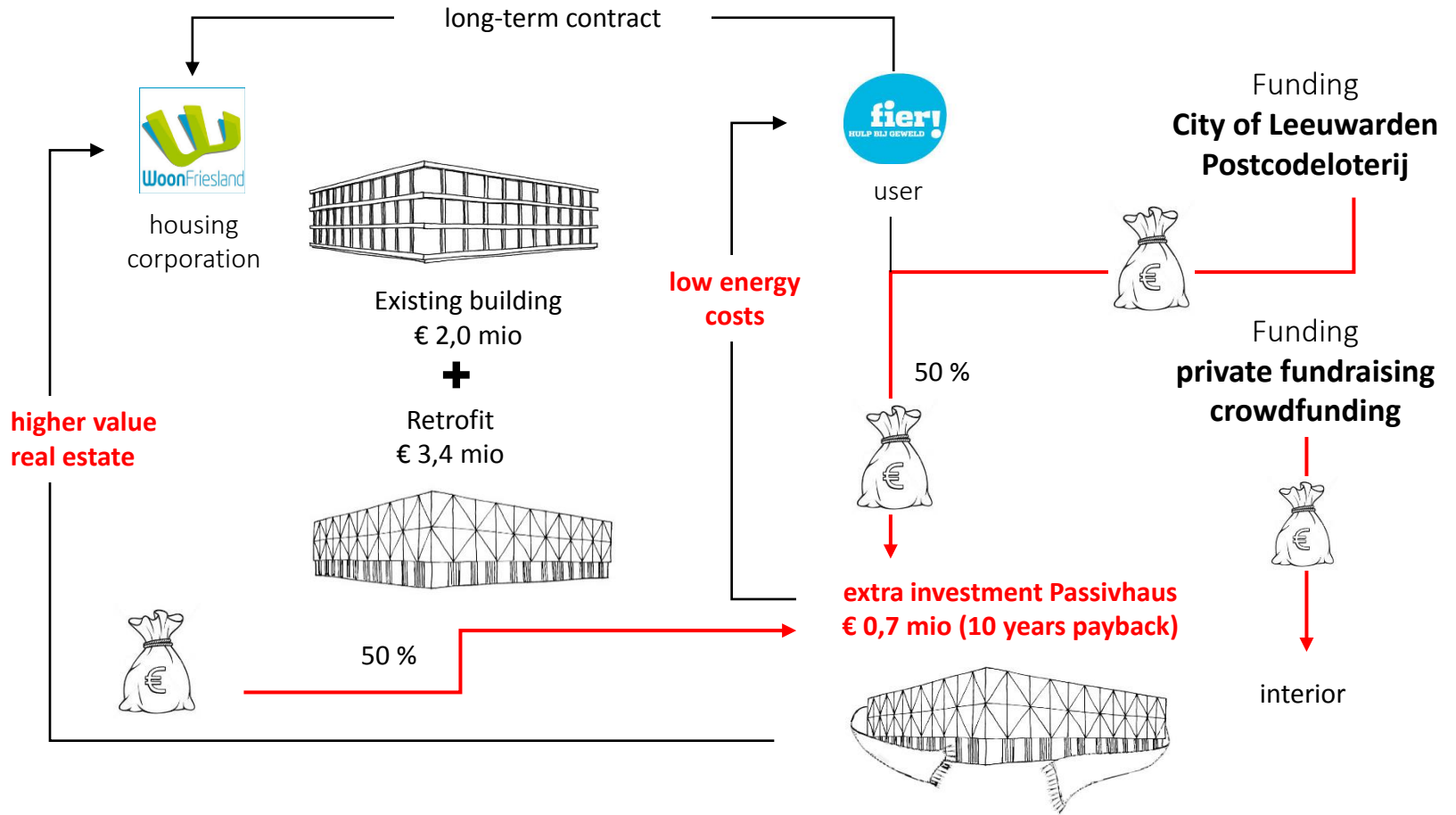

The concept

low costs | high quality

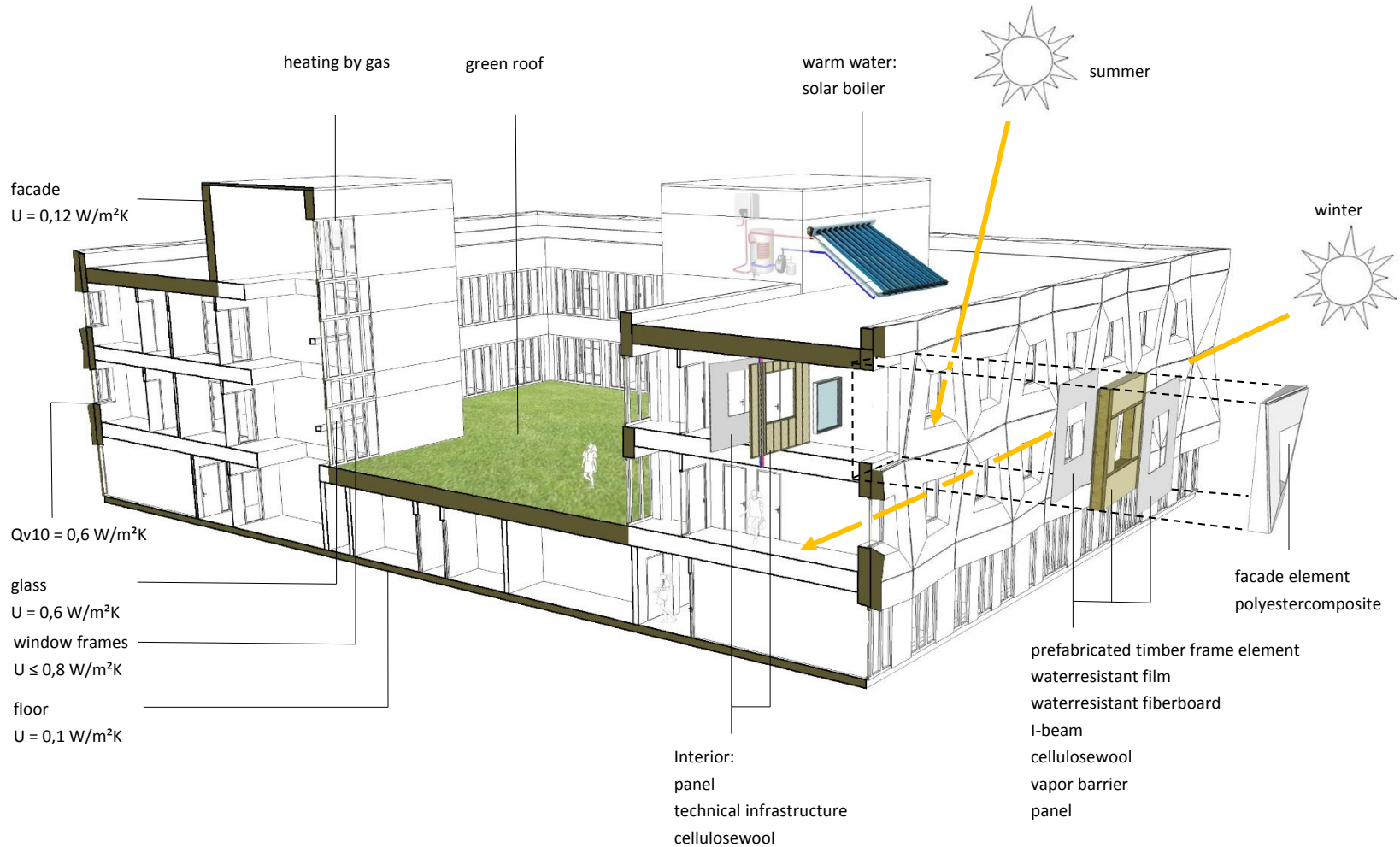

The concept

low costs | high quality

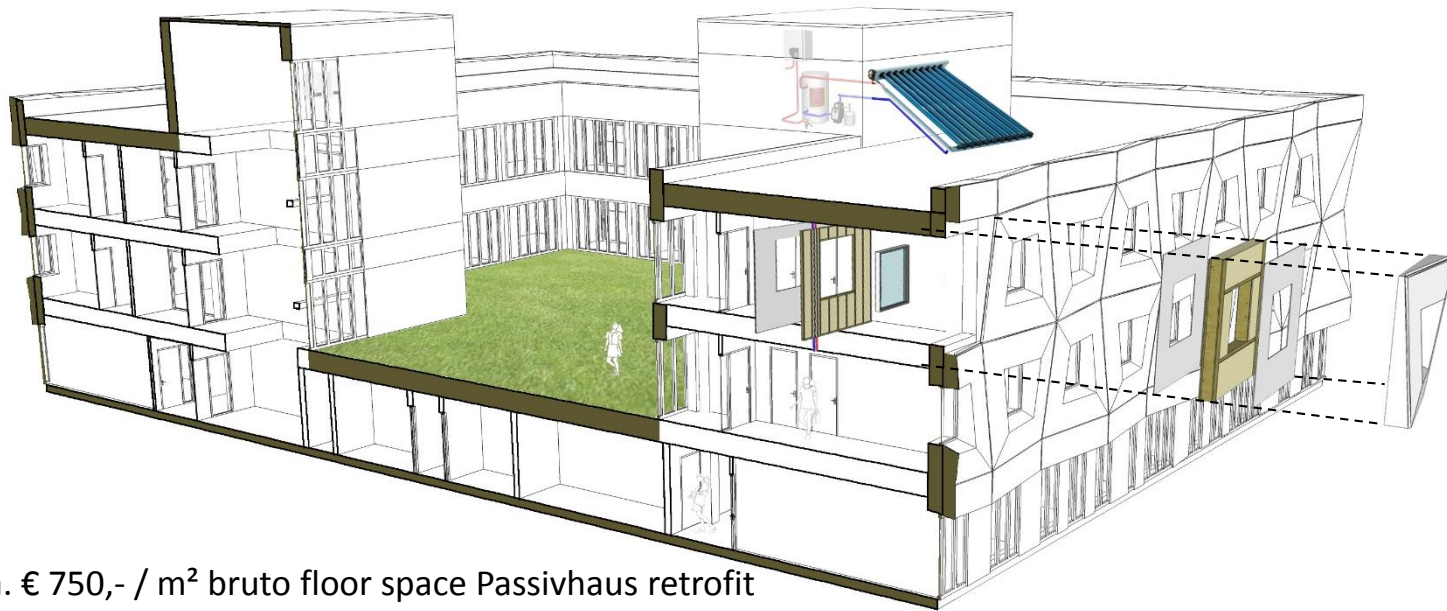

ca. € 750,- / m² bruto floor space Passivhaus retrofit

ca. € 1.100,- / m² bruto floor space complete object

ca. € 1.400,- / m² netto floor space

Calculatede reduction use of gas from 210.000 m³ to 25.000 m³ / a (in use 21.000 m³)

Construction time: 8 months

A cooperative performance

Hedy d'Ancona Award 2014
Sustainable Award 2012
Nomination Passivhaus Award 2012
1. Renovation of an office building Passivhaus NL



Kooperative Architecture Workshop

Start: 1. May 1976



Traditional model

Against each other | competition

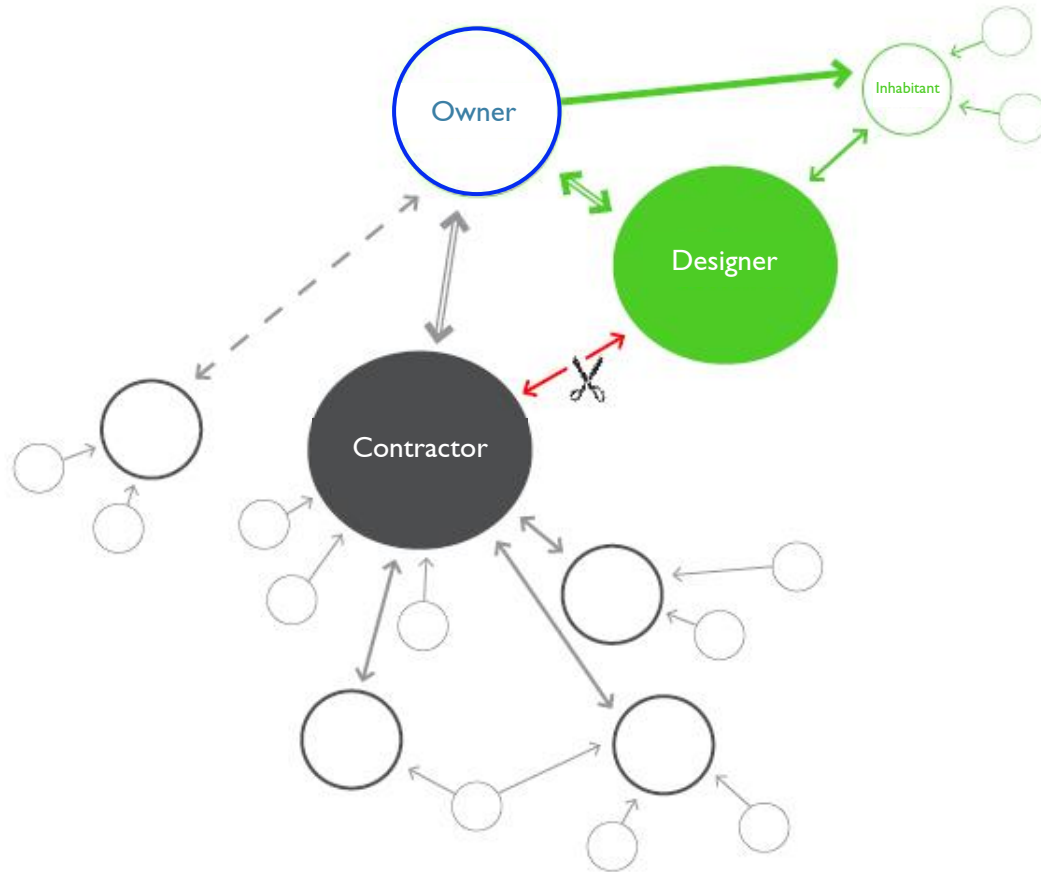

Innovative

Together | cooperation | integral team

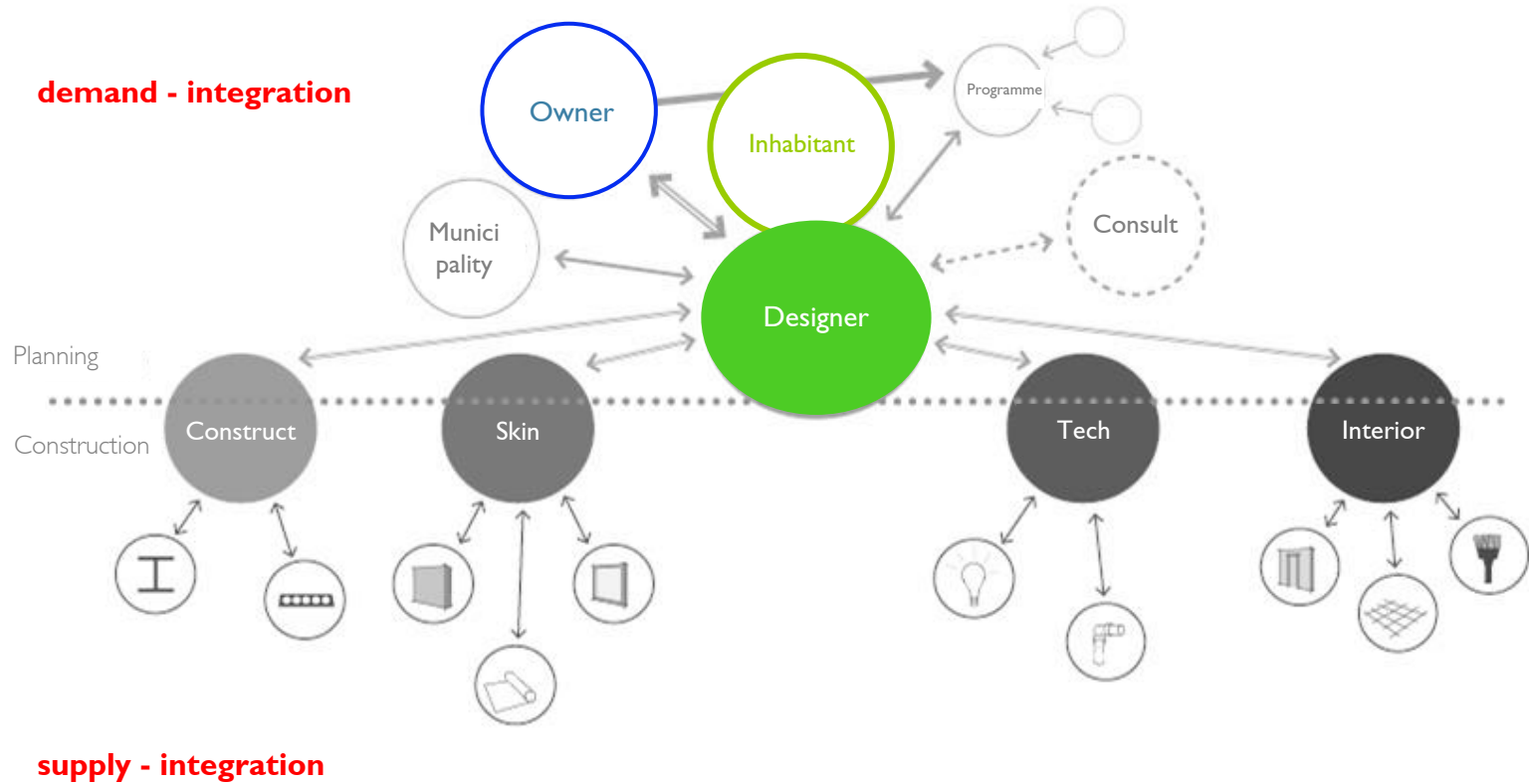

Cooperative

Working together for the same goal

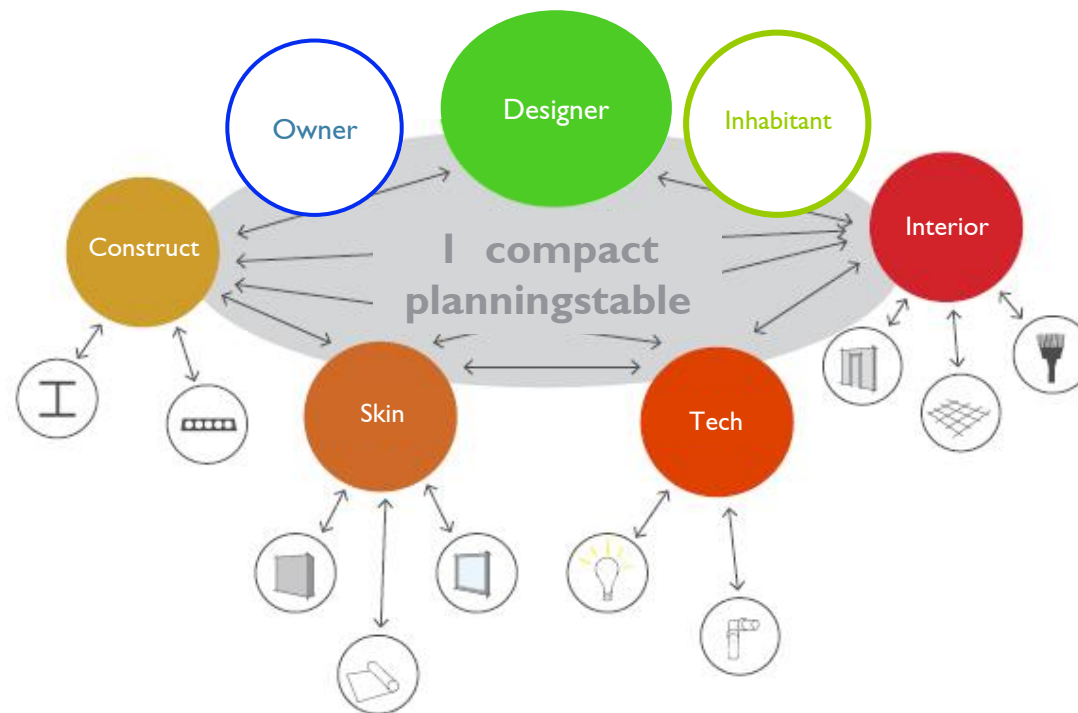

Process tools

What we use

3D modelling BIM

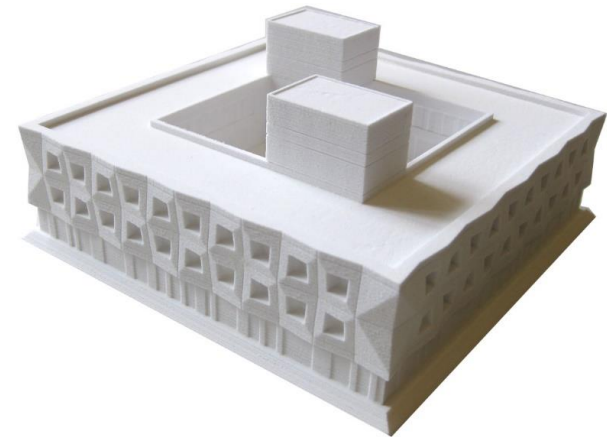
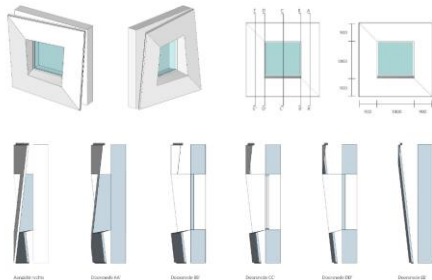

3D print models



Online Platform



Communication strategy

The future of our energy bill

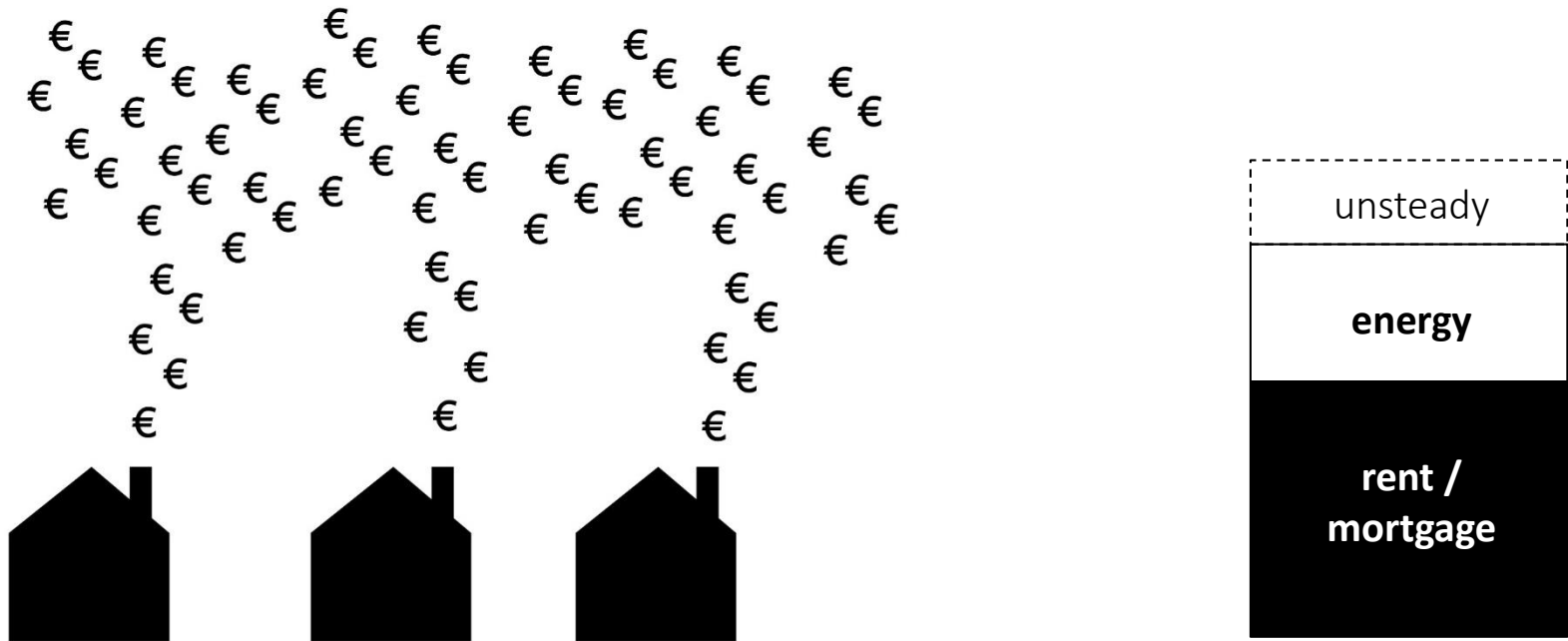

Why not spend the money better?

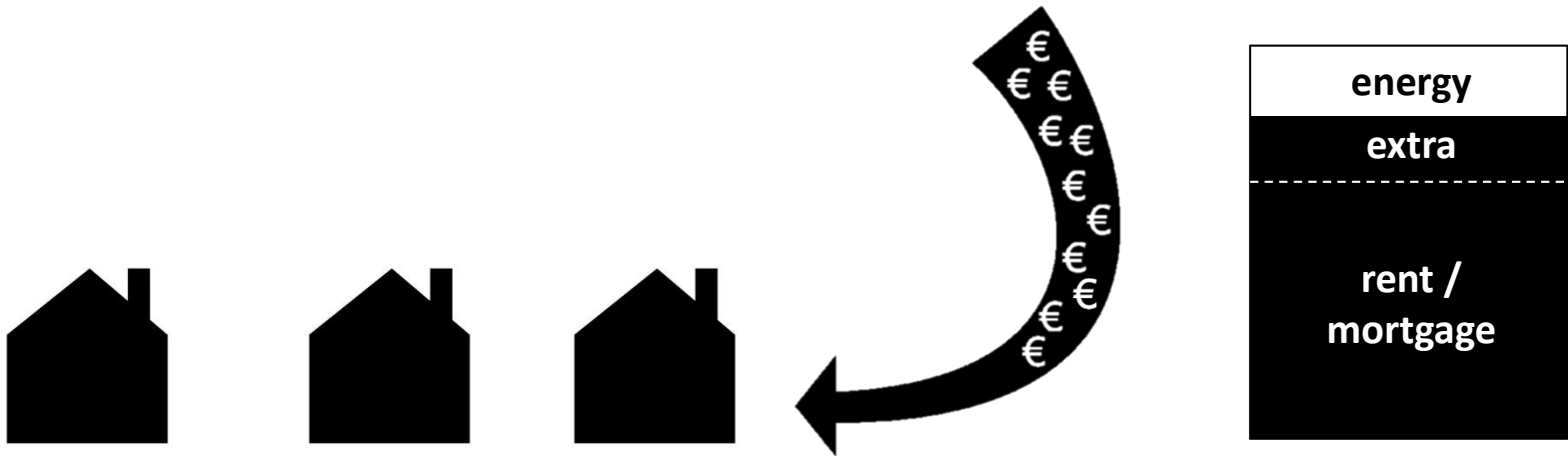

Nul-op-de-meter (NOM) as funding for sustainable retrofit

about € 45.000,- invest
fixed price
energybundle

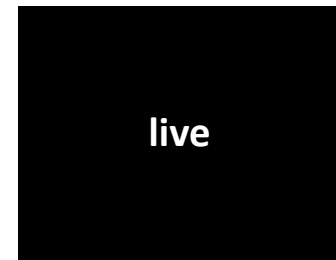

Why not bring home to the present times?

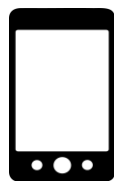
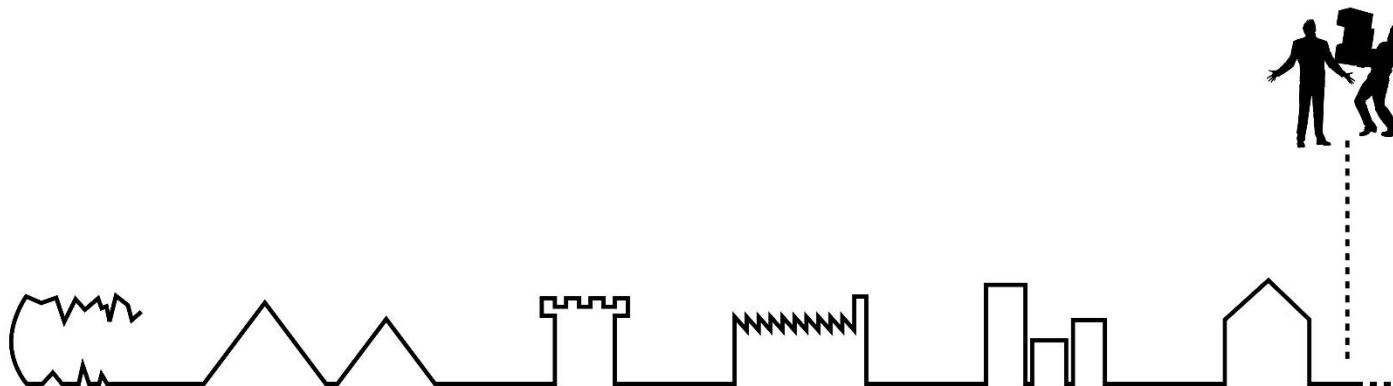

communication



mobility



information

Why not buy retrofit like a regular product in a supermarket?



REIMARKT



Retail store in 4 Dutch cities
1st shop worldwide to buy sustainable retrofit

“it’s maintenance-free”

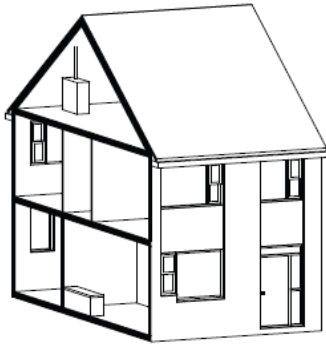

“you get more comfort”



“bigger value”

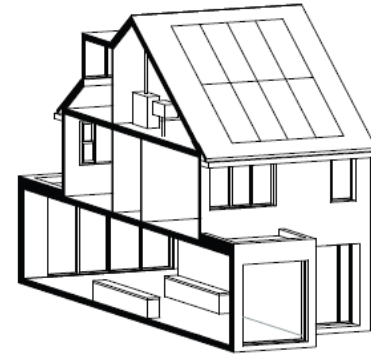

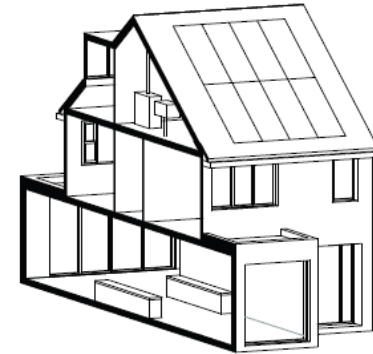
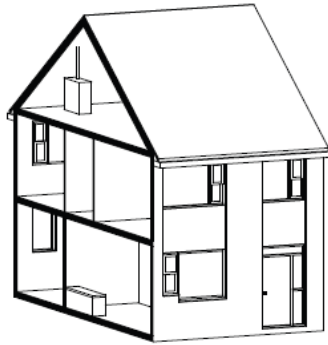

“I can stay home”



“I can chose”

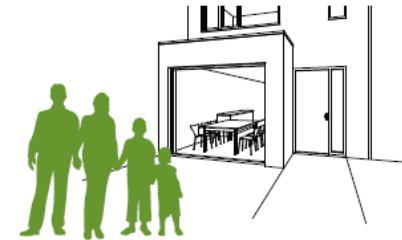

“my house can grow
with my family”



ALLROUND
★★★★★

MINDER ENERGIE
★★★★★

Instappakket voor lagere energiekosten en meer comfort in huis!

REIMARKT ALLROUND



SAFE
★★★★☆

LANGER WONEN
★★★★☆

Met dit product koop je een drempelvrije slaapkamer en een badkamer op de begane grond!

REIMARKT

SAFE



ALLROUND
★★★★☆

MINDER ENERGIE
★★★★☆

Instappakket voor lagere energiekosten en meer comfort in huis!

REIMARKT

ALLROUND



AVANTGARDE
★★★★★

GROTER WONEN
★★★★★

Reimarkt FAMILY voor het grootste gezin in elke woning!

REIMARKT AVANTGARDE



SAFE
★★★★☆

LANGER WONEN
★★★★☆

Met dit product koop je een drempelvrije slaapkamer en een badkamer op de begane grond!

REIMARKT SAFE



ALLROUND
★★★★☆

MINDER ENERGIE
★★★★☆

Instappakket voor lagere energiekosten en meer comfort in huis!

REIMARKT ALLROUND



From proces to product

Semi-finished products

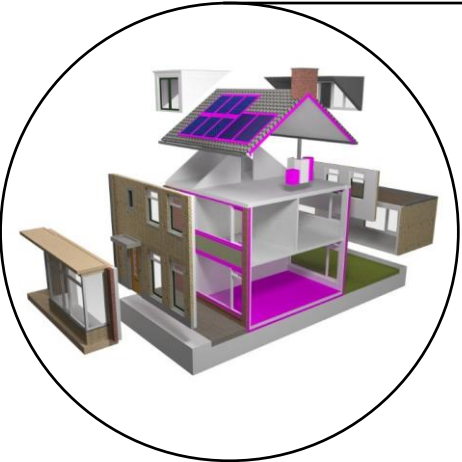

Product



XXL



L



S



Urban patterns and typologies

The next steps

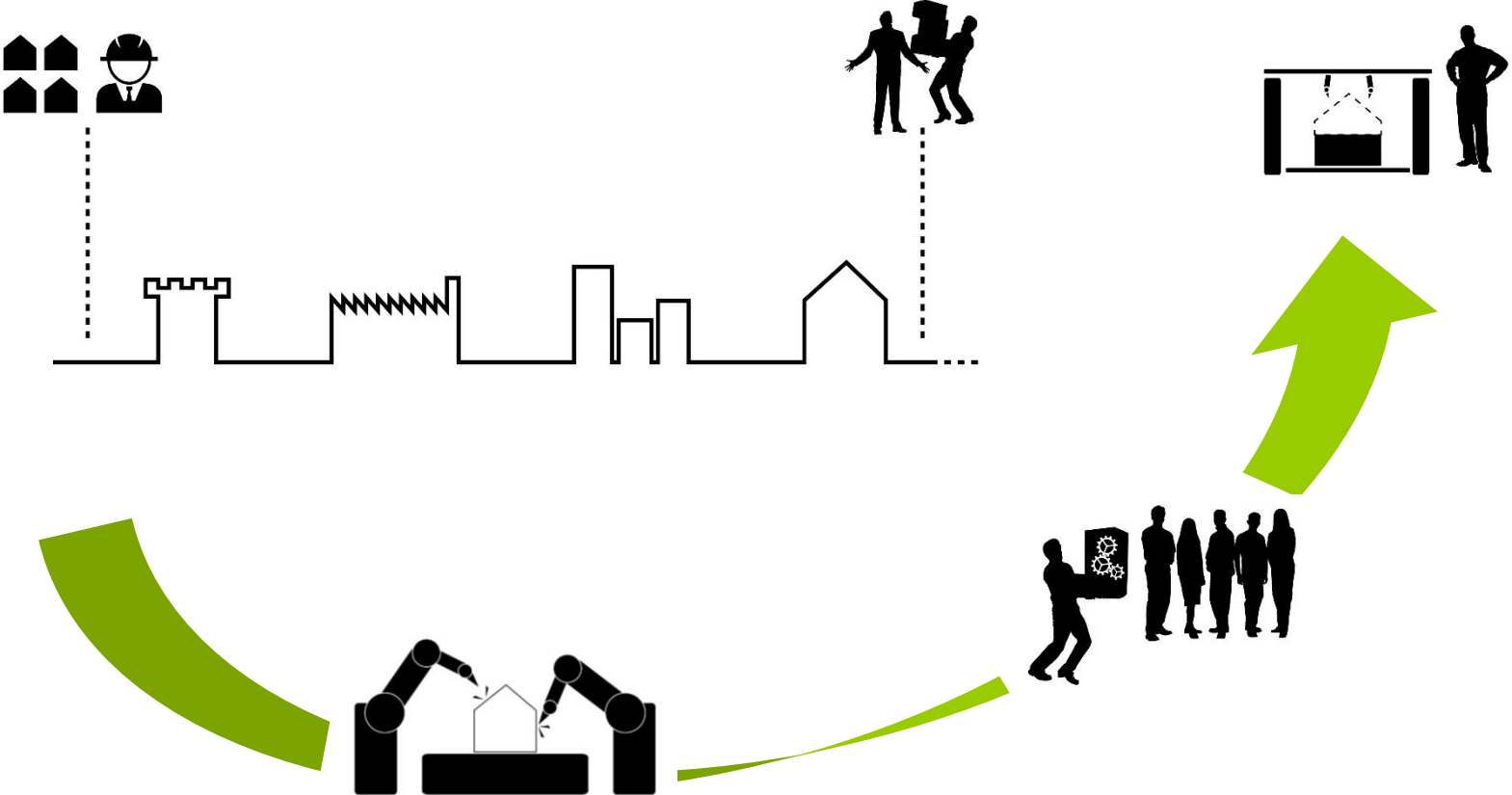

ir. Reimar von Meding architect | partner | executive board member

r.v.meding@kaw.nl

+31 (0) 6 54 69 77 41

@reimaronmeding

info@kaw.nl

www.kaw.nl/en

@KAWarchitecten

KAW Groningen Kattenhage 1 9712 JE GRONINGEN | Postbus 1527 9701 BM GRONINGEN

KAW Rotterdam Van Nelleweg 2426 3044 BC ROTTERDAM

KAW Eindhoven Bloemfonteinstraat 62 – lokaal 14 5642 EH EINDHOVEN

+31 (0) 88 529 00 00 info@kaw.nl www.kaw.nl

